

hanskonner

hanskonner®

HCD20600BL

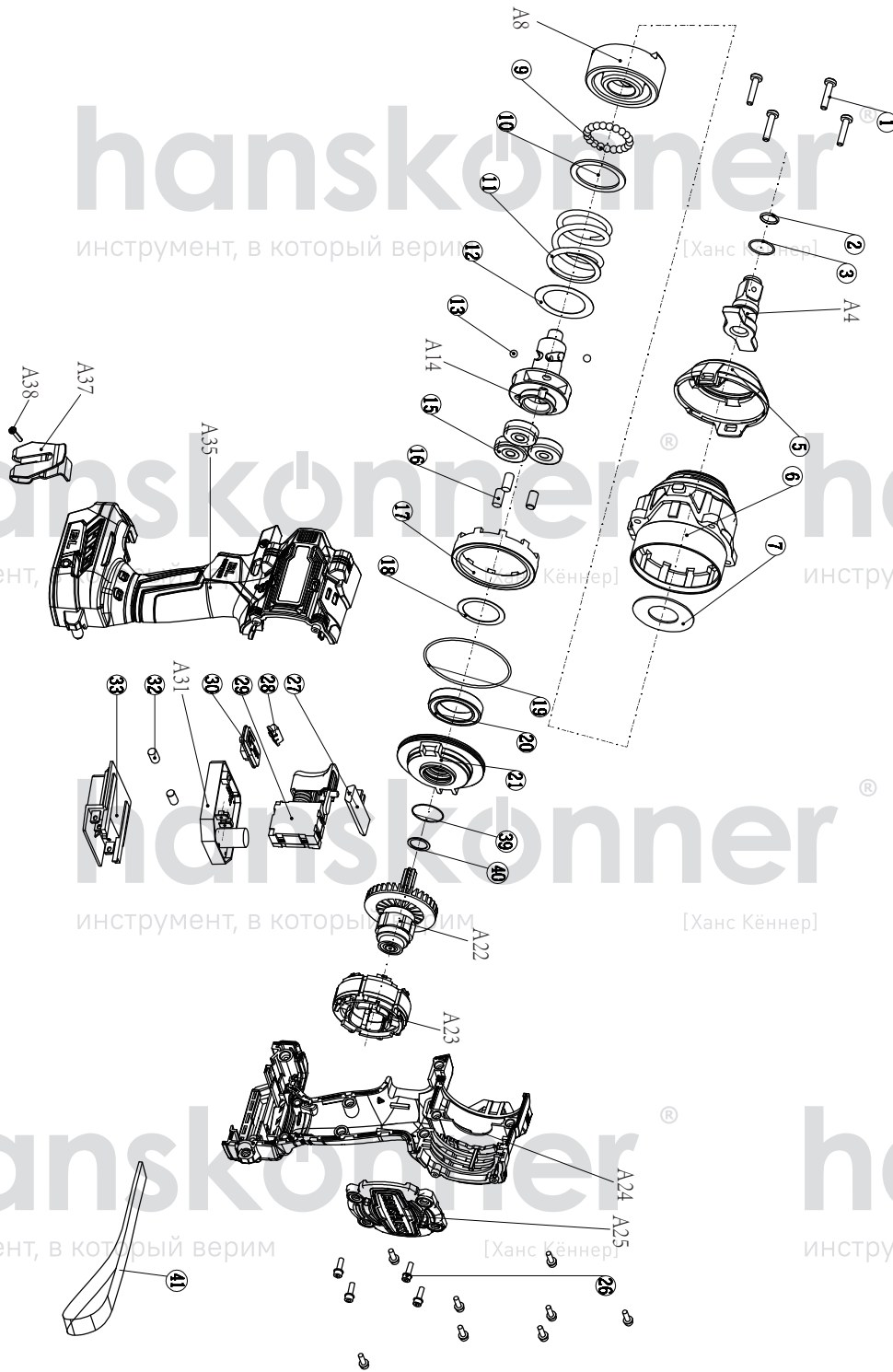

NO.	DESCRIPTION
1	Screw ST4.0X20
2	o-ring
3	Circlip
A4	Output shaft
5	rubber cover
6	Gear box
7	Washer
A8	Impact block
9	steel ball $\varnothing 3.5$
10	Washer
11	spring
12	Washer
13	steel ball $\varnothing 5.5$
A14	Intermediate shaft
15	planet gear
16	pin $\varnothing 6 \times 12$
17	Gear ring
18	Washer $\varnothing 26 \times \varnothing 33 \times 0.5$
19	o-ring
20	bearing 6805RS
21	Gear ring cover
A22	Rotor
A23	Stator
A24	Right housing
A25	rear cover
26	Screw ST3X16
27	Direction switch
28	LED cover
29	switch
30	Speed control button
A31	Motor PCB
32	Rubber column
33	connection foot
A35	Left housing
A37	Hook
A38	Screw ST5X10
39	o-ring
40	Sealing gasket
41	Hang rope

HCD20600BL-EX-RU260521-3 ver2.1

hanskonner

hanskonner